

**LOCAL &  
DETOUR SHUTTLE**

**EFFECTIVE 3/25/13**

**Ingersoll/  
Valley  
Junction**



Service Monday - Friday  
No Holiday service.

BUSES WILL RUN SATURDAY SERVICE  
THE DAY AFTER THANKSGIVING.

**Platform N**

**Route Destinations:** ▼

Valley Junction ▼

Ingersoll Ave ▼

Downtown ▼

DART Central Station ▼



*Ride for a Reason*

Accessible



All Trips

**Pass Sales Outlets**

**Dahl's Food Marts**

- 3425 Ingersoll Avenue - Rt #11, #60
- 1819 Beaver Avenue - Rt #5
- 3400 E. 33rd Street - Rt #1, #17
- 4121 Fleur Drive - Rt #8
- 4343 Merle Hay Road - Rt #14, #91
- 1320 E. Euclid Avenue - Rt #4
- 8700 Hickman Road, Clive - Rt #93, #92
- 15500 Hickman Road, Clive ^ - #92
- 5440 NW 86th, Johnston - Rt #93
- 1802 N. Ankeny Blvd., Ankeny \* - Rt #98
- 1208 Prospect Road, West Des Moines - Rt #96
- 5003 E.P. True Parkway, West Des Moines - Rt #96, #52

**Hy-Vee Food Stores**

- 3330 Martin Luther King Jr. Parkway - Rt #16 17.50
- 2540 E. Euclid Avenue - Rt #17 7.50
- 3221 S.E. 14th Street - Rt #6
- 4707 Fleur Drive - Rt #8
- 1107 E. Army Post Road - Rt #6, #7
- 8601 Douglas Avenue, Urbandale - Rt #93, #73
- 1700 35th Street, West Des Moines - Rt #3, #52, #72, #94
- 1990 Grand Avenue, West Des Moines - Rt #96
- 555 S. 51st Street, West Des Moines - Rt #52, #96
- 1725 Jordan Creek Pkwy, West Des Moines\* - Rt #52, #94, #95, #72
- 7101 University Avenue, Windsor Heights - Rt #3
- 100 8th Street S.W., Altoona - Rt #99
- 4815 Maple Drive, Pleasant Hill \* - Rt #1
- 410 N. Ankeny Blvd., Ankeny - Rt #98

**DART Administrative Offices** – 620 Cherry Street

**E-Z Money Check Cashing** –

- 2910 E. University - Rt #1
- 1238 E. 14th - Rt #4, #17
- 904 Army Post Road - Rt #7

**Hy-Vee Drugstore** – 42nd & University Avenue - Rt #3, #60

**Passageway** – 15th & Walnut - Rt #11, #60

**Wal-Mart** –

- 1002 S.E. National Drive, Ankeny \* - Rt #98
- 1001 73rd St., Windsor Heights \* - Rt #3

Routes are listed next to the Pass Sales Outlet locations they service. Next nearest route(s) are also listed.

\* Locations where tokens are not available.

^ Only Express Plus passes.

+ Passes only for Monthly, Half-Fare Monthly, and Monthly Express Plus (no tokens or weekly).

**Fares**

**Local Routes**

Adult .....	\$ 1.75
Half-Fare* .....	\$ .75
Children 6 - 10 .....	\$ .75
Children 5 and under .....	FREE

(Must be accompanied by an adult)

**Express Routes**

Cash .....	\$ 2.00
Half-Fare* .....	\$ .75

**Transfers**

Request when boarding. Valid two hours after issued.

Local to Local .....	FREE
Local to Express .....	\$ .25
Local to Flex/On Call .....	\$ 1.75
Express to Flex/On Call .....	\$ 1.50
Half-Fare* .....	FREE

**Tokens**

Tokens must be purchased in packages of 10.

Full Fare .....	10/\$
Half-Fare (Reduced Fare ID*) .....	10/\$

**Passes**

Weekly (Local) .....	\$16.00
Half-Fare Weekly*^ .....	\$ 7.00
(Local, Express & Flex/On Call)	
Monthly (Local) .....	\$48.00
Half-Fare Monthly*^ .....	\$24.00
(Local, Express & Flex/On Call)	
Monthly Express Plus .....	\$58.00
(Local, Express & Flex/On Call)	

**Flex/On Call Service**

Cash .....	\$ 3.50
Half-Fare* .....	\$ .75

**Zone Fares**

Downtown Loop Cash (No transfers issued) .....

Applies to all routes going through downtown. You must begin and end your ride within the zone. Boundaries are: South of I-235 to Cherry/Court Ave. (including DART Central Station), East of W. 15th St. to E. 14th St.

**Please Remember ...**

DART requires exact fares and all special IDs upon boarding. All DART locations are smokefree pursuant to the Iowa Smokefree Air Act.

Transfer times are not guaranteed.

**CUSTOMER SERVICE** ..... **515-283-8100**

\*Applies to Elderly (65+), persons with disabilities, Medicare card holders and Veterans with a Service Connected ID.

^Applies to middle and high school students with current school year ID. Student discount not valid with cash or tokens and valid only on Local, Express and Flex Routes.

May be asked for additional identification to validate use/sale of half-fares or passes. Additional forms of identification include a driver's license, Veterans Service Connected ID, or a photo ID presented with a Medicare Card, SSI Disability Card, and DART Half-Fare/Reduced Fare ID.

**Des Moines Area Regional Transit Authority**  
620 Cherry Street, Des Moines, Iowa 50309  
[www.ridedart.com](http://www.ridedart.com)



**Route 11**  
**Ingersoll/Valley Junction**  
**Monday - Friday Service**

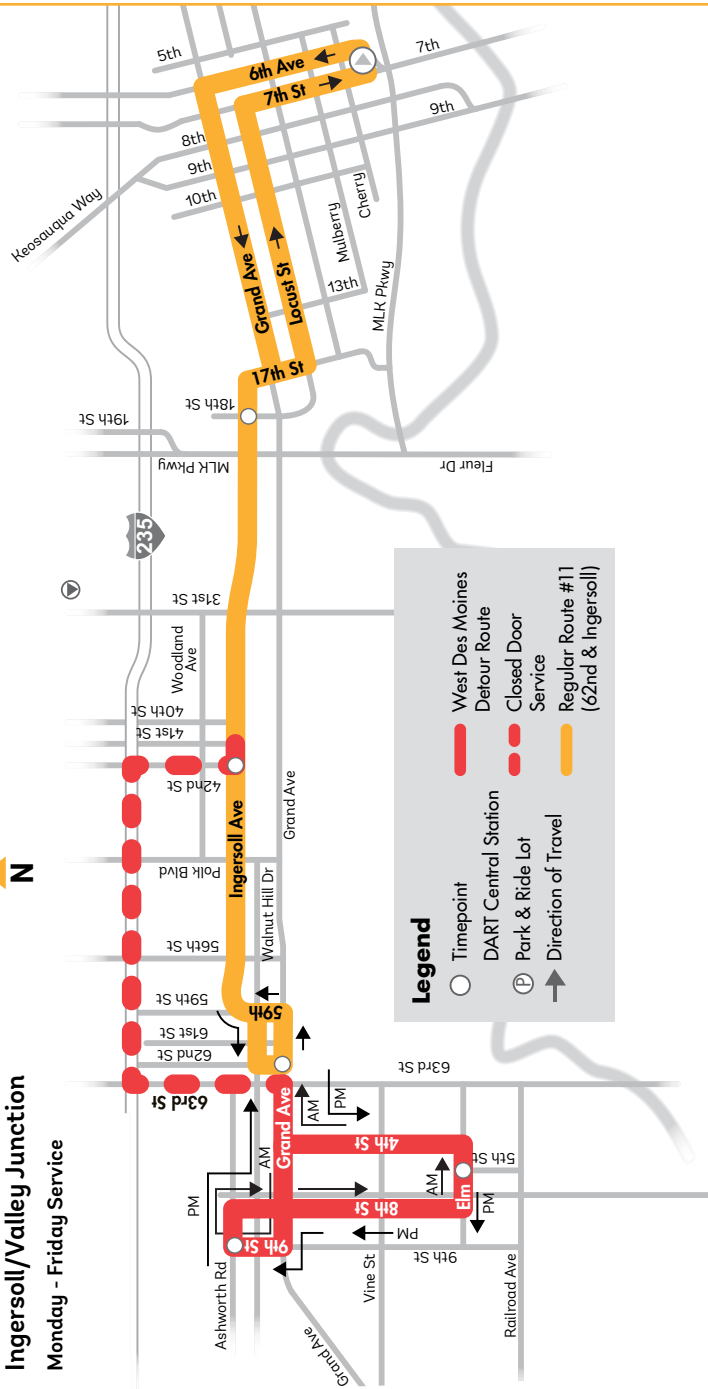

### EASTBOUND-Inbound Monday-Friday

Street Cross St	9th St & Ashworth	Elm St & 5th St	62nd St & Grand Ave	Ingersoll Ave & 42nd St	Ingersoll Ave & 18th St	DART Central Station
<b>AM</b>	5:45	5:50	----	6:00	----	----
	----	----	5:55	6:00	6:07	6:15
	6:42	6:46	----	7:00	----	----
	----	----	6:55	7:00	7:07	7:15
<b>PM</b>	7:42	7:47	----	8:00	----	----
	----	----	7:55	8:00	8:07	8:15
	3:48	----	----	3:59	----	----
	----	----	3:54	3:59	4:06	4:15
	5:10	----	----	5:20	----	----
	----	----	5:15	5:20	5:26	5:35

### WESTBOUND-Outbound Monday-Friday

Street Cross St	DART Central Station	Ingersoll Ave & 18th St	Ingersoll Ave & 42nd St	62nd St & Grand Ave	Elm St & 5th St	9th St & Ashworth
<b>AM</b>	6:20	6:27	6:33	6:39	----	----
	----	----	6:33	----	----	6:42
	7:20	7:27	7:33	7:39	----	----
	----	----	7:33	----	----	7:42
<b>PM</b>	3:20	3:27	3:33	3:39	----	----
	----	----	3:33	----	3:44	3:48
	4:40	4:47	4:55	5:01	----	----
	----	----	4:55	----	5:06	5:10
	5:25	5:32	5:39	5:45	----	----
	----	----	5:39	----	5:49	5:53

Weather, special events and traffic conditions may alter service.



**CHECK OUT**  
[www.ridedart.com](http://www.ridedart.com)

▶▶▶  
**Schedules and Maps**  
 For all other routes

◀◀◀  
**DART Services**  
 Latest information and changes

▶▶▶  
**Employer Support Program**

Currently, around **60 organizations** in the Des Moines area offer this benefit, paying up to **100%** of employees' monthly transit fares.

◀◀◀  
**Transit Advertising**  
 Get county-wide coverage by advertising on DART buses.



**Downtown Loop Zone.....\$0.75**  
 Applies to all routes going through downtown. You must begin and end your ride within the zone. (No transfers issued)

- Boundaries are:
- ▶ North - I-235 (Freeway)
  - ▶ West - W. 15th St.
  - ▶ South - Cherry/Court Ave. (Including DART Central Station)
  - ▶ East - E. 14th St.